

# Run for the Last Mile 5K 2024 | Wayne, NJ

**START:** On West Rd, even with the center of the fire hydrant on the right (SE) side of the road near the SW corner of Speert Hall. 14 feet past (NE of) the concrete wall next to the bus stop (also on the right). [40.946084, -74.200342](tel:40.946084,-74.200342)

**FINISH:** On the walkway approaching Machuga Student Center. Even with the leading (SW) edge of the metal drainage grate across the walkway and 15 feet before (SW of) the leading (SW) edge of the unmarked light pole (L.P.) on the left (NW) side. [40.945399, -74.199209](tel:40.945399,-74.199209)

**Black Arrows = Section 1**  
**Magenta = Section 2**  
**Blue = Section 3**  
**Red = Section 4**  
**Dashed Arrows = Paths/Sidewalks**

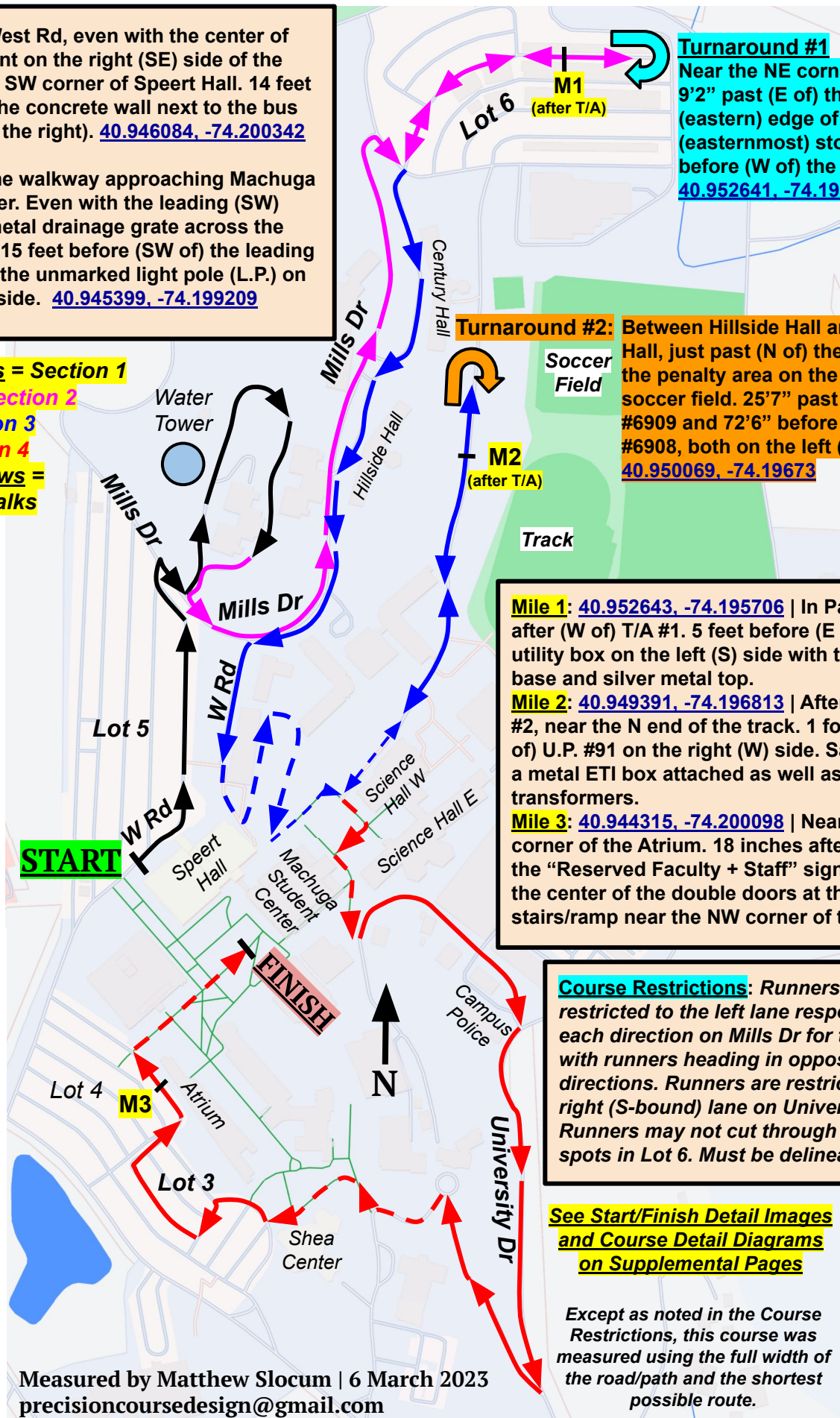

**Turnaround #1:** Near the NE corner of Lot 6. 9'2" past (E of) the trailing (eastern) edge of the final (easternmost) storm drain before (W of) the stop sign. [40.952641, -74.195098](tel:40.952641,-74.195098)

**Turnaround #2:** Between Hillside Hall and Century Hall, just past (N of) the N edge of the penalty area on the S side of the soccer field. 25'7" past (N of) U.P. #6909 and 72'6" before (S of) U.P. #6908, both on the left (W) side. [40.950069, -74.19673](tel:40.950069,-74.19673)

**Mile 1:** [40.952643, -74.195706](tel:40.952643,-74.195706) | In Parking Lot 6, after (W of) T/A #1. 5 feet before (E of) the utility box on the left (S) side with the concrete base and silver metal top.

**Mile 2:** [40.949391, -74.196813](tel:40.949391,-74.196813) | After (S of) T/A #2, near the N end of the track. 1 foot after (S of) U.P. #91 on the right (W) side. Said U.P. has a metal ETI box attached as well as transformers.

**Mile 3:** [40.944315, -74.200098](tel:40.944315,-74.200098) | Near the NW corner of the Atrium. 18 inches after (NW of) the "Reserved Faculty + Staff" sign. 28'6" after the center of the double doors at the top of the stairs/ramp near the NW corner of the bldg.

**Course Restrictions:** Runners are restricted to the left lane respectively in each direction on Mills Dr for the section with runners heading in opposite directions. Runners are restricted to the right (S-bound) lane on University Dr. Runners may not cut through parking spots in Lot 6. Must be delineated.

**See Start/Finish Detail Images and Course Detail Diagrams on Supplemental Pages**

Except as noted in the Course Restrictions, this course was measured using the full width of the road/path and the shortest possible route.



# START/FINISH DETAIL IMAGES

**START:** On West Rd, even with the center of the fire hydrant on the right (SE) side of the road near the SW corner of Speert Hall. 14 feet past (NE of) the concrete wall next to the bus stop (also on the right). [40.946084, -74.200342](#)

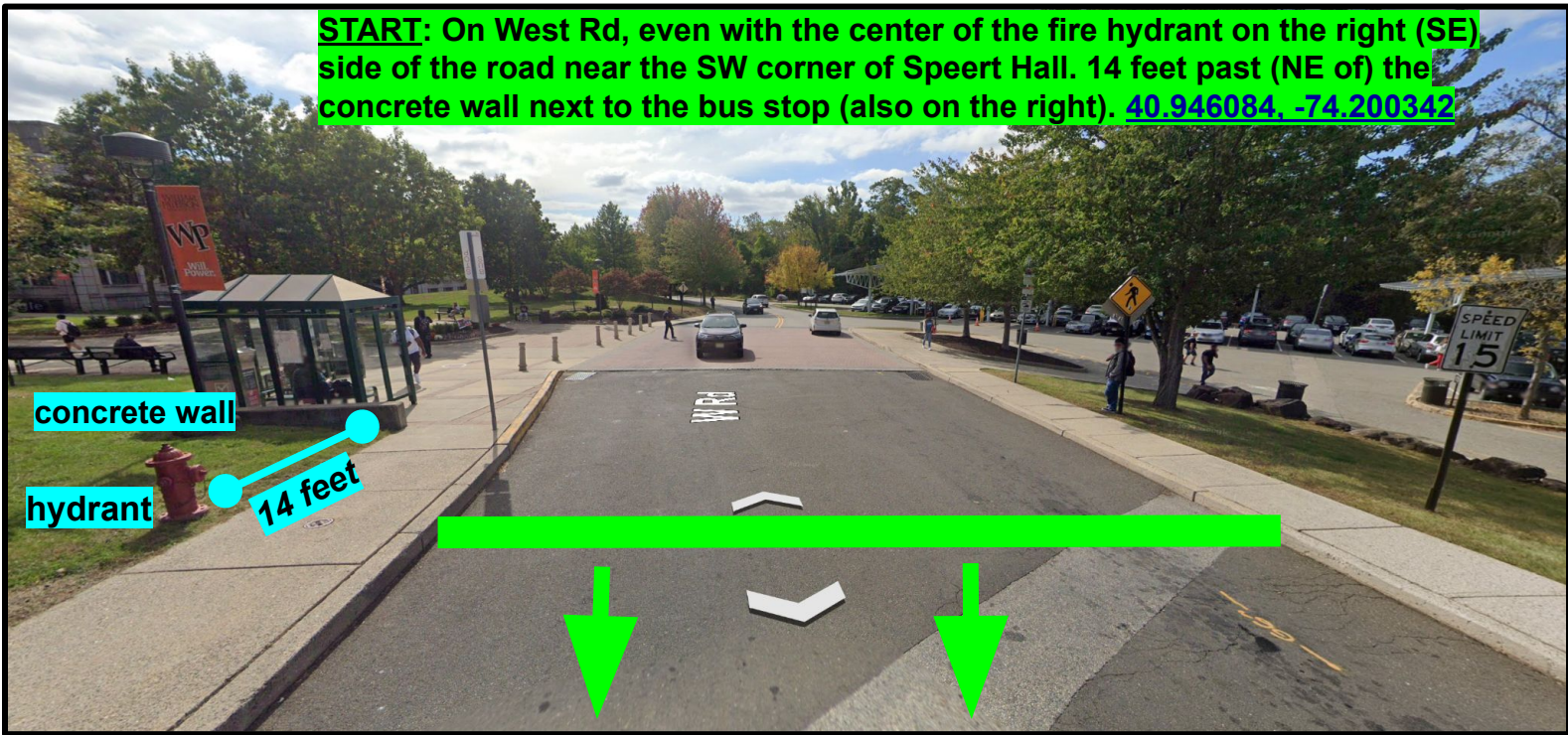

**FINISH:** On the walkway approaching Machuga Student Center. Even with the leading (SW) edge of the metal drainage grate across the walkway and 15 feet before (SW of) the leading (SW) edge of the unmarked light pole (L.P.) on the left (NW) side. [40.945399, -74.199209](#)

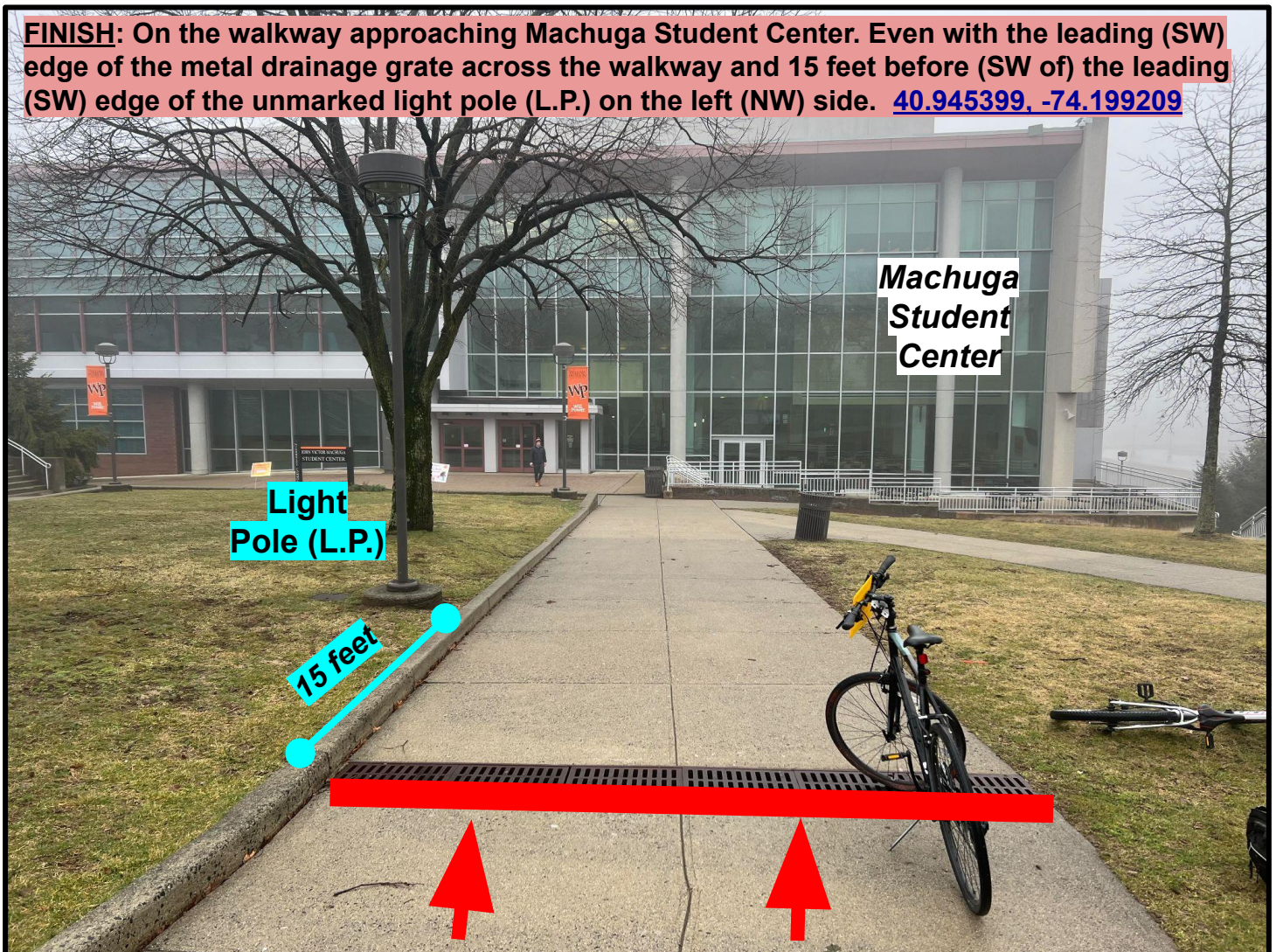



# TURNAROUND 1 + 2 DETAIL DIAGRAMS

**Turnaround 1:** Near the NE corner of Lot 6. 9'2" past (E of) the trailing (eastern) edge of the final (easternmost) storm drain before (W of) the stop sign. [40.952641, -74.195098](#)

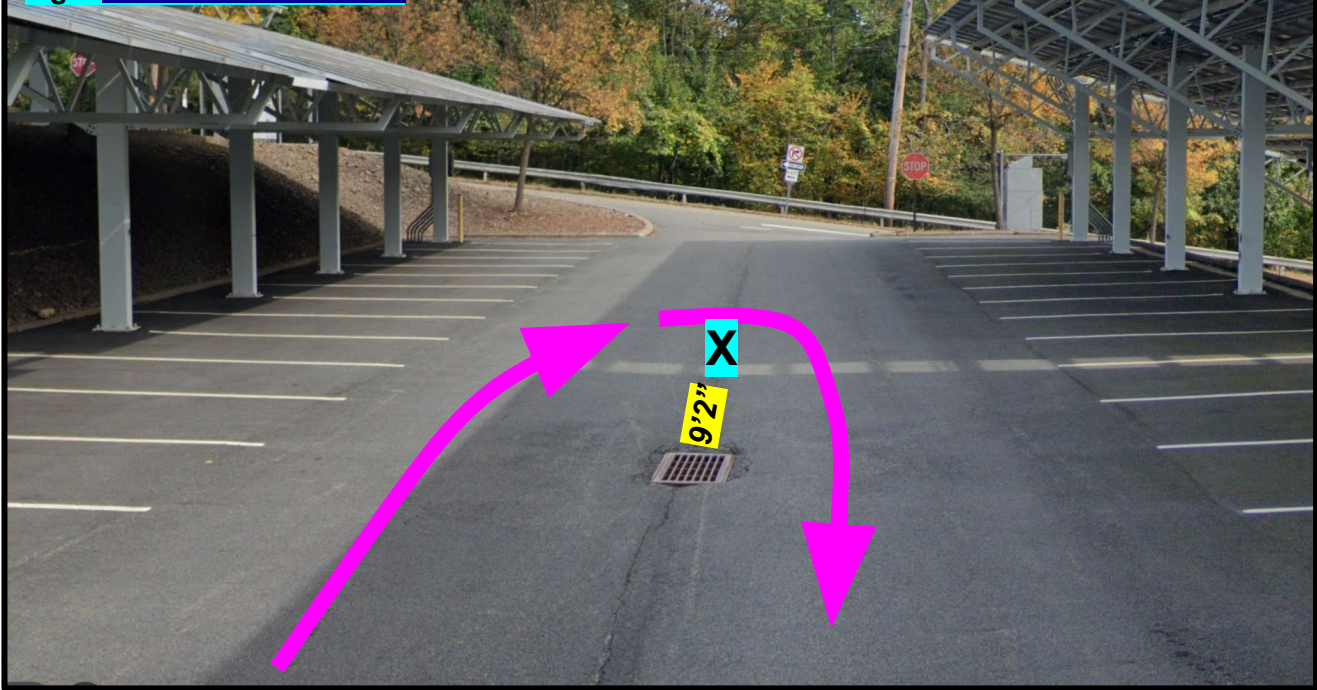

**Turnaround 2:** Between Hillside Hall and Century Hall, just past (N of) the N edge of the penalty area on the S side of the soccer field. 25'7" past (N of) U.P. #6909 and 72'6" before (S of) U.P. #6908, both on the left (W) side. [40.950069, -74.19673](#)

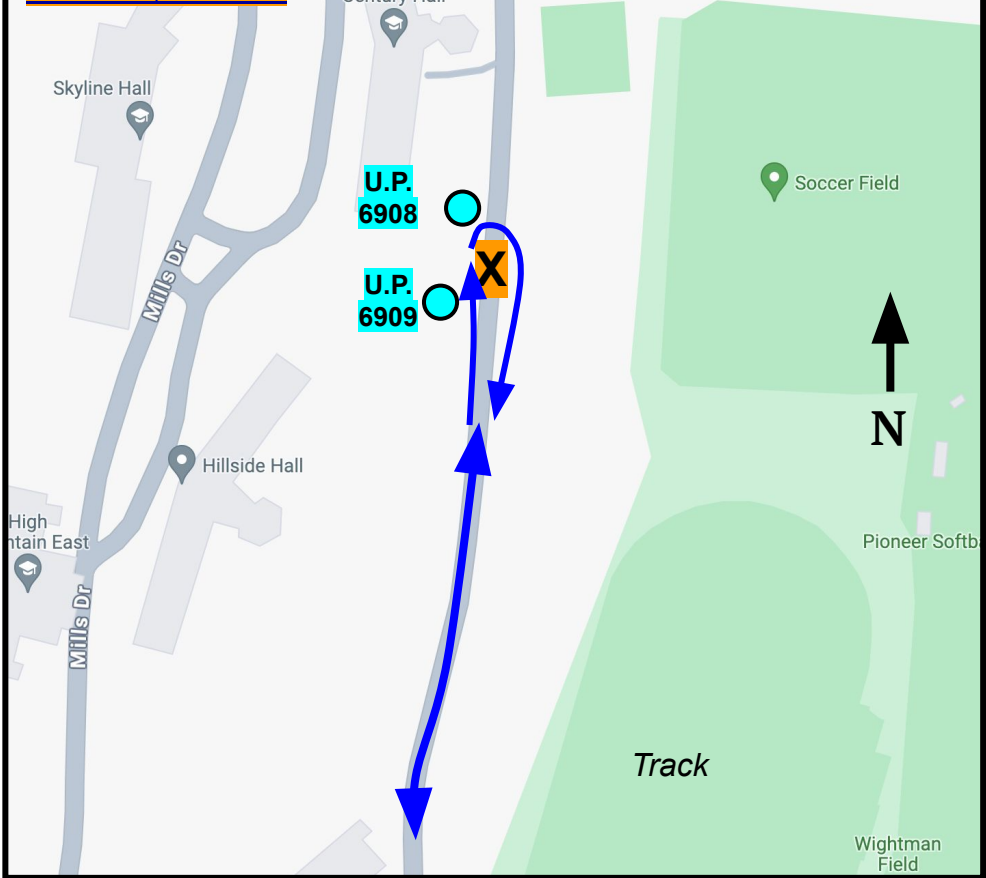

**COURSE**  
**DETAIL:**  
***Section 1***

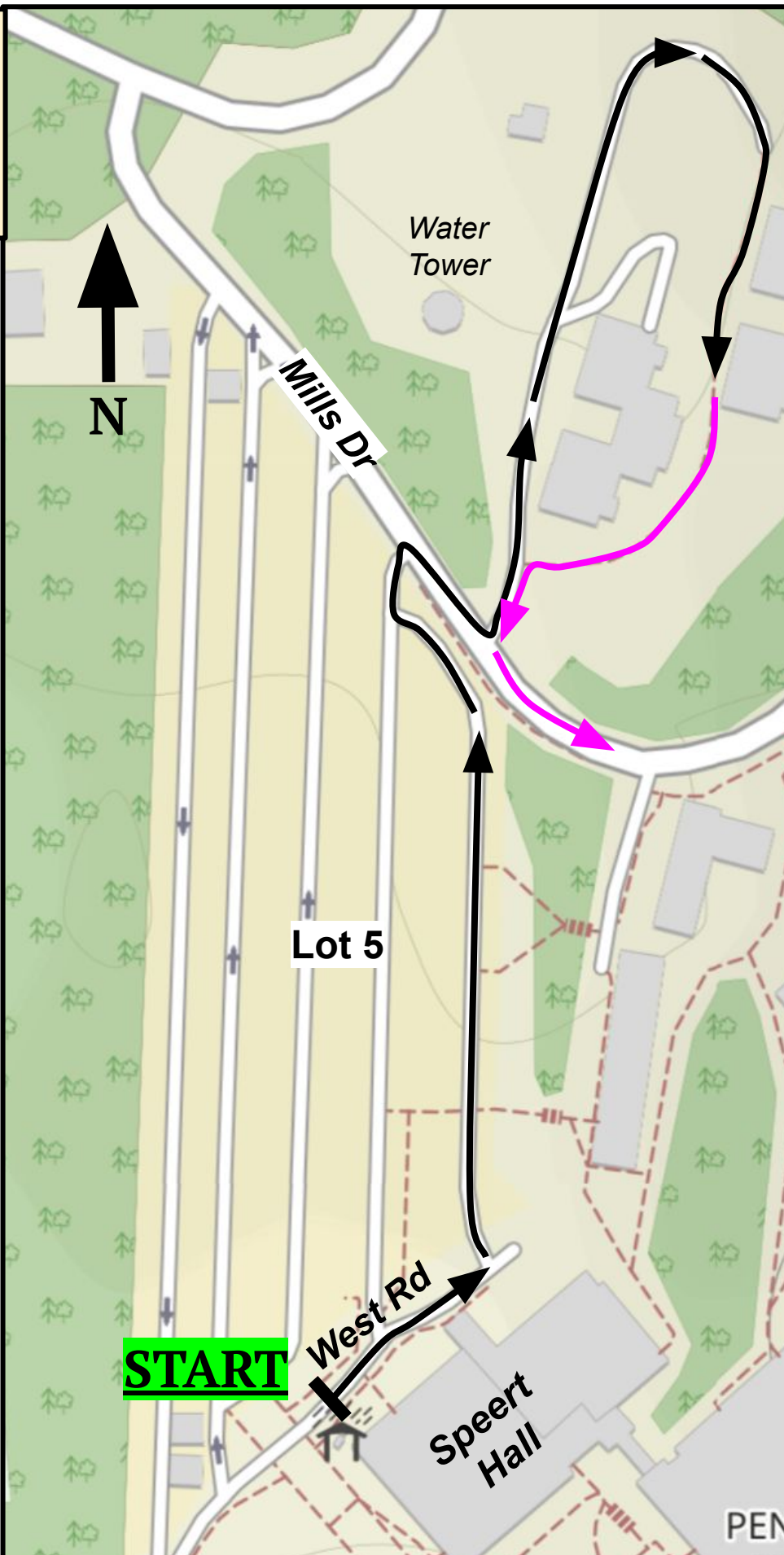



# **COURSE DETAIL: Section 2 + 3 (part 1)**

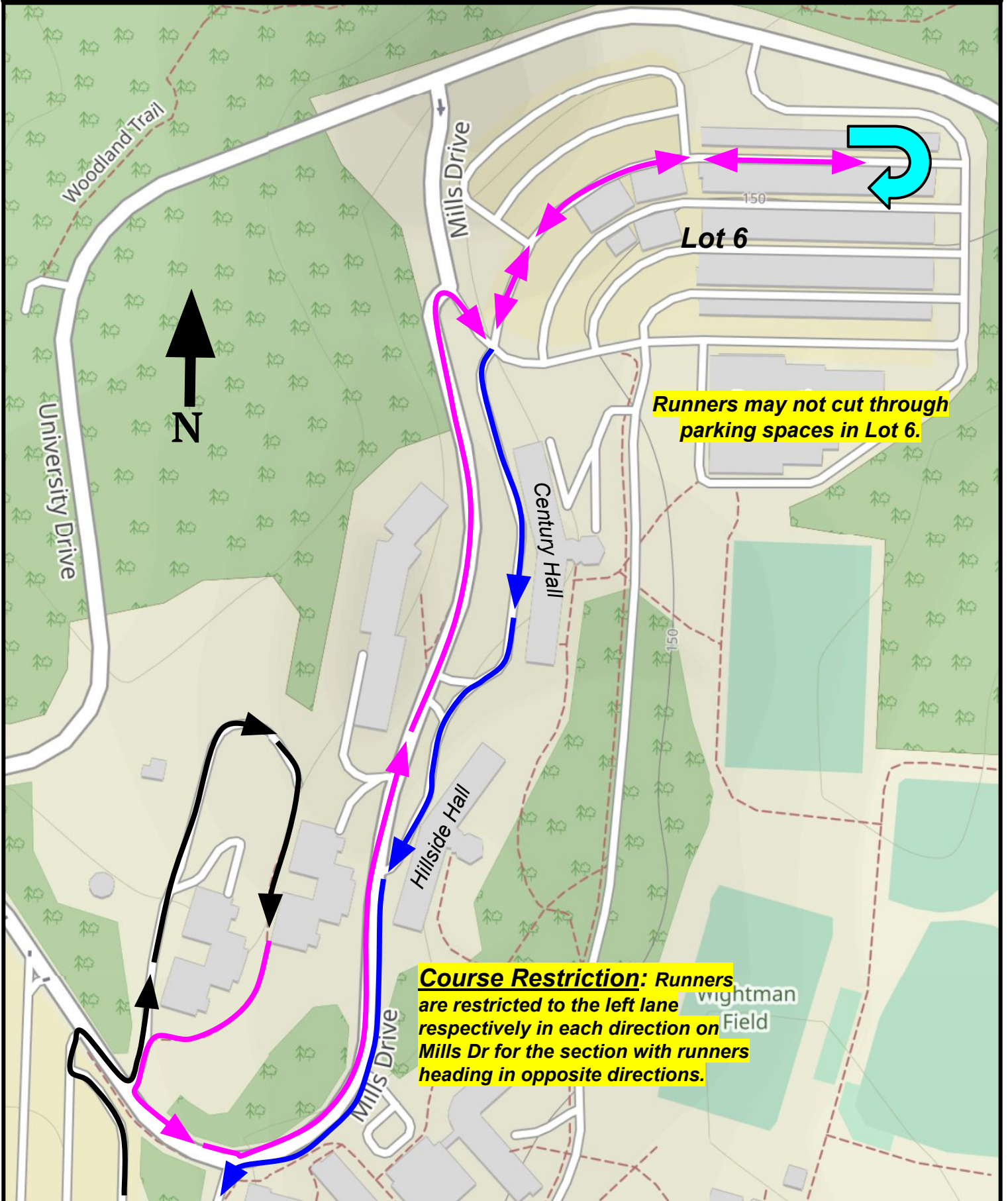

**Runners may not cut through parking spaces in Lot 6.**

**Course Restriction: Runners are restricted to the left lane respectively in each direction on Mills Dr for the section with runners heading in opposite directions.**

# COURSE DETAIL: Section 3 + 4 (part 1)

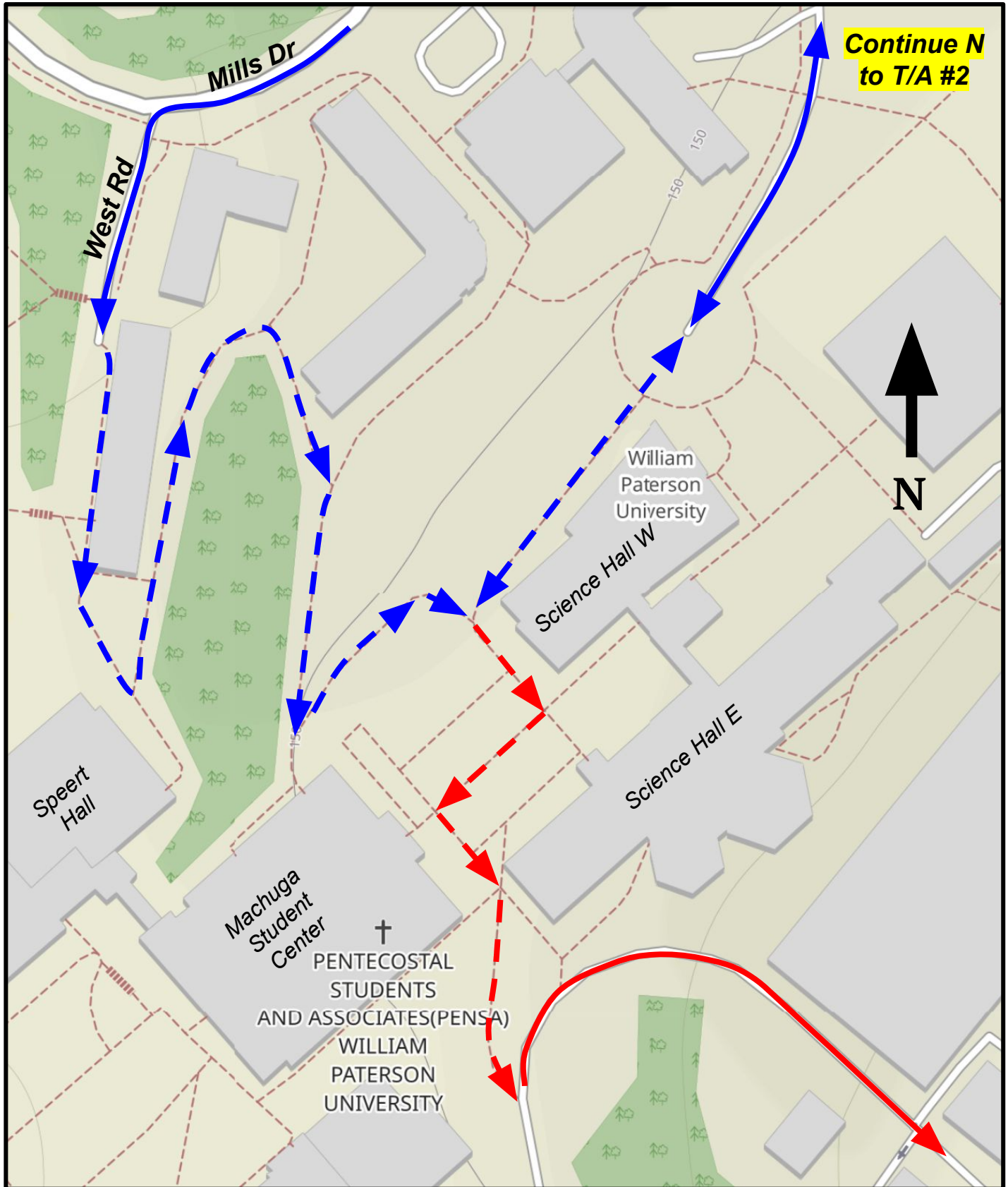



# COURSE DETAIL: Section 4 (part 2)

