

floorplan

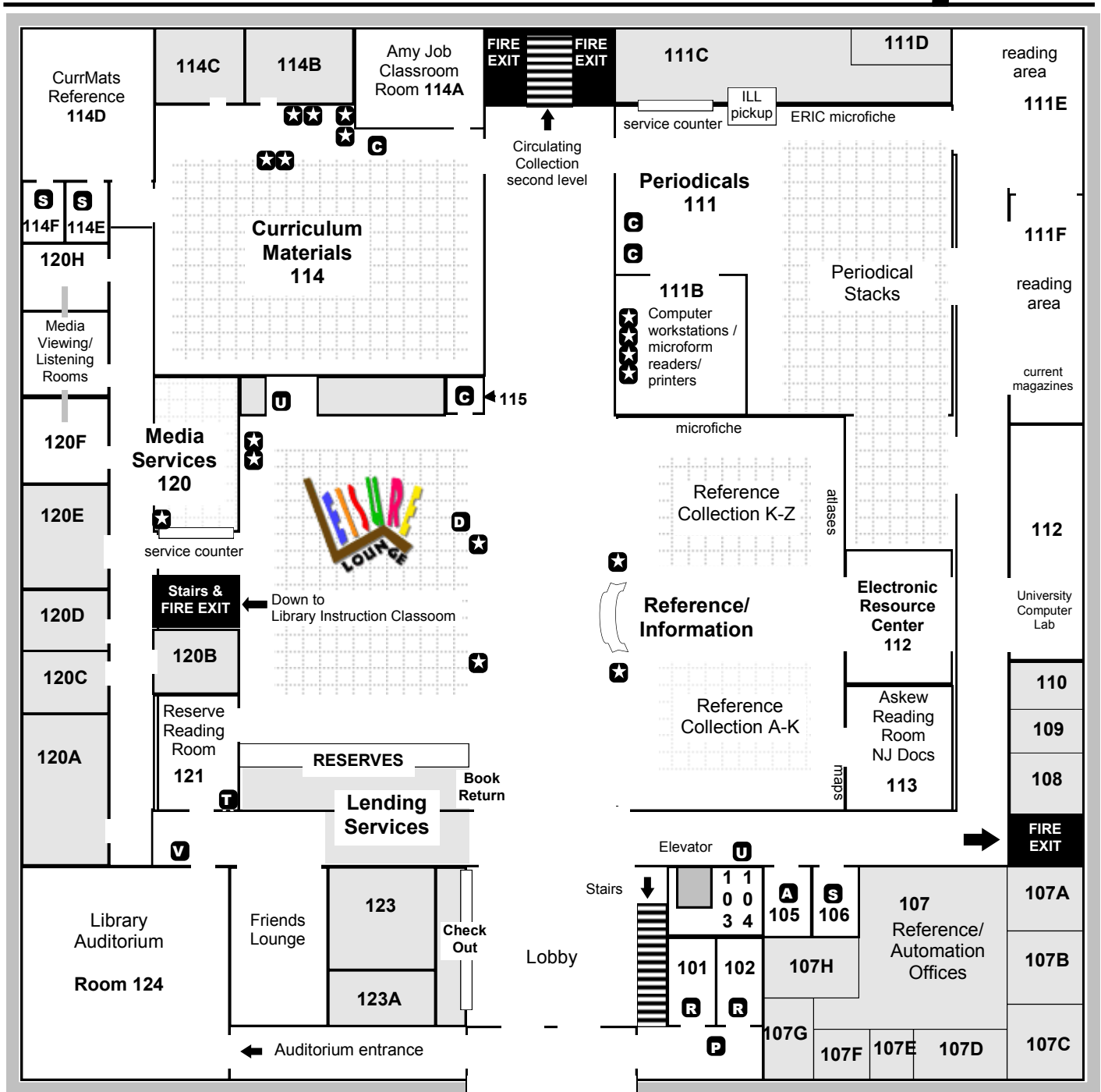

- ★ Online catalog / computer wkstn
- S Study room
- C Copiers
- R Restroom
- P Telephone
- A Adaptive Technology Room
- V Vending machine
- D Dictionary stand
- T Typewriter
- Staff areas
- Book/media collection
- U Campus phone

Entrance

- Copiers are located throughout the Library. Copy cards may be purchased in the copier room on the first level.
- Reference Desk 973-720-2116
- Media Services 973-720-2308
- Lending Services 973-720-3180
- Periodicals 973-720-2114
- Library Hours 973-720-2541
- Book Renewal 973-720-3803

For additional information about the Library, connect to the Library's Web site at www.wpunj.edu/library

SECOND LEVEL

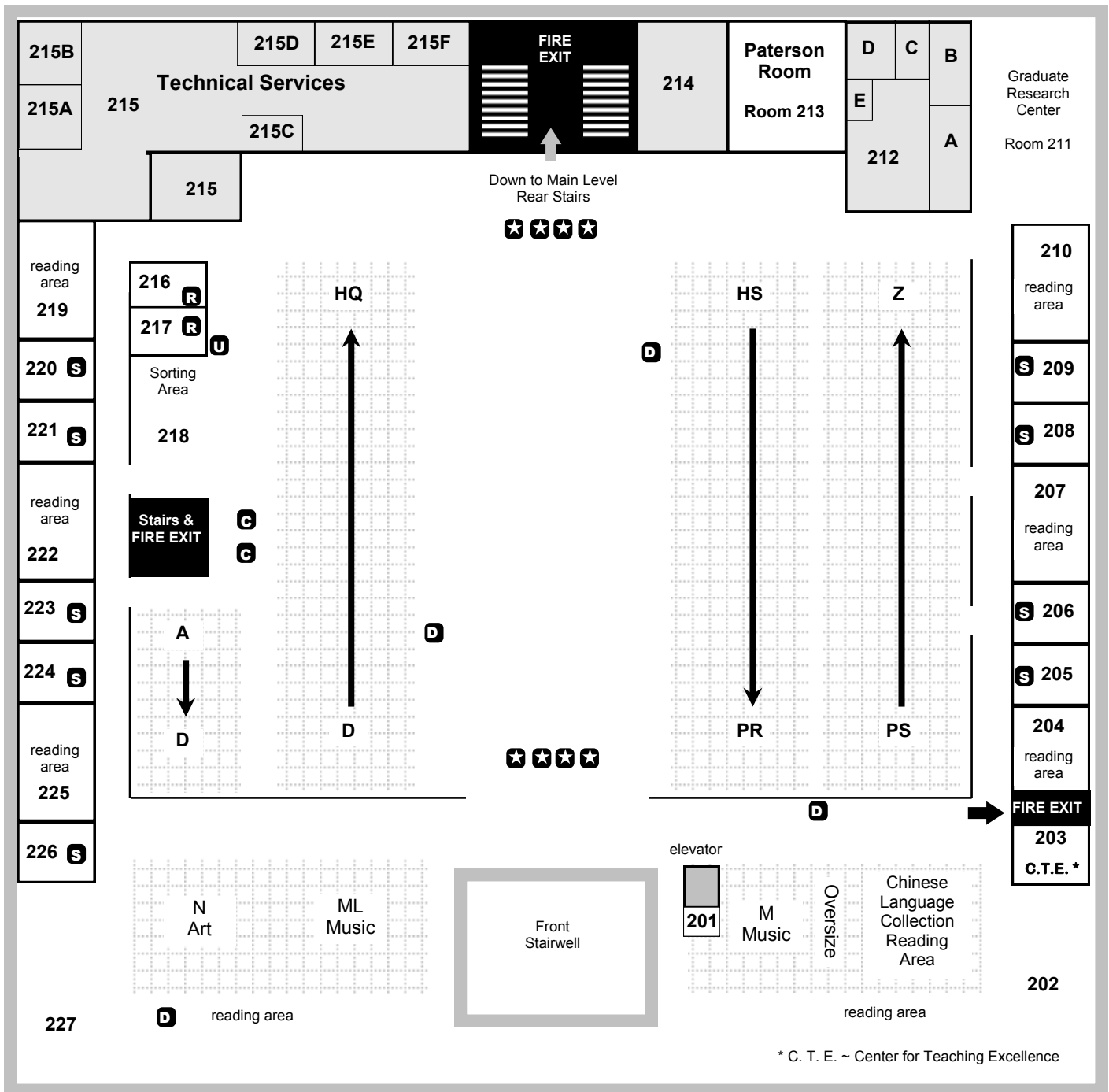

Group Study Rooms

Group study rooms are available on both floors of the Library. They are available on a first-come, first-served basis and may not be reserved. Groups of three or more have priority for study room use. Dry markers and erasers may be borrowed at the Lending Services Desk for use on study room boards. A valid student I.D. or driver's license is required.

Graduate students may reserve carrels in the Graduate Research Center on the main level. Call Library Administration at 973-720-2113 for details.